



Epson SureColor SC-S40600

- Produce durable outdoor signs & banners, window & back-lit displays, wallpaper & decor, vehicle wraps & POS, labels & more...
- Compatible with coated & uncoated paper, vinyl, canvas, mesh, film, & synthetic stocks
- Superior imaging with low grain, enhanced gamut, contrast & gloss levels
- Supports tiling applications with exceptional colour, consistency & print linearity
- Low running cost with rapid job set-up, minimum maintenance, low power & ink consumption
- Easy to operate with a see-through platen cover, remote management & status notification
- Efficient operation with integrated auto take-up, auto media setup & skew correction
- Enhanced reliability with a self cleaning printhead, headguard, & air filtration system
- Suits installation in factory, shop & air-conditioned studio environments
- High durability with flexible cover extendable up to FIVE YEARS
- Ships complete with NEW Epson Edge Print Software

Epson SureColor SC-S40600

Product Specifications

PRINTING TECHNOLOGY	
Print Engine	Self-cleaning Epson PrecisionCore™ TFP with VSDT Epson Precision Dot Technology Integrated headguard
Media Handling	Auto media setting, auto skew correction, advanced auto tension control (Ad-ATC) & auto take-up (ATU) Optional print drying system 1440 x 1440 dpi Max Res, 4.2 pl min drop size
Print Quality	
INK SYSTEM	
Type	Epson UltraChrome® GS3 Eco-Solvent
Colour Set	CMYK
Loading	4 x 700 ml cartridge
PRINT SPEEDS ¹	
Draft	58.4 m2/h
Billboard	29.4 m2/h
Banner	16.6 m2/h
Vinyl, Canvas & Paper	10.5 m2/h
Film (Front & Backlit)	3.5 m2/h
MEDIA HANDLING	
Sizing	300-1626 mm (64") wide, 1 mm max thickness
Input	Single roll, 45 kg max weight, 250 mm max diameter
Output	Sheet (manual cut) or roll (200 mm max diameter)
Drying	Individually adjustable input, platen & output heaters
REMOTE MANAGEMENT	
Features	See-through platen with LED lighting On-board 2.7" Colour LCD Panel Remote e-mail status & error reporting Ships with Epson Edge Print & Dashboard software. Compatible with a wide range of 3rd party RIP and workflow applications.

INTEGRATION	
Space Requirements	3.6 x 2.7 x 1.7 m (WxDxH)
Operational Temp	15 to 35°C (20 to 32°C recommended)
Operational Humidity	20 to 80% (40 to 60% recommended)
Power Requirement	2x 240 V, 50/60 Hz, 5 A
Power Consumption	480 W operating/ 12 W Sleep
Operational Noise	59 dB
Connectivity	USB2.0, 100BASE-TX/1000BASE-T
OPTIONS	
C12C932381	Optional print drying system
1YWSCS40600	1Yr CoverPlus On-Site Service Extension
2YWSCS40600	2Yr CoverPlus On-Site Service Extension
CONSUMABLES	
C13T724100	Maintenance cleaning kit
C135210044	Maintenance parts kit
C13T699300	Ink cleaner
C13T833192	700 ml black ink cartridge
C13T833292	700 ml cyan ink cartridge
C13T833392	700 ml magenta ink cartridge
C13T833492	700 ml yellow ink cartridge
C13T833092	cleaning cartridge
C13T835192~492	700 ml Colour 3M™ MCS™ Ink Cartridges ²
CONFIGURATION OPTIONS	
SCS406001YR	Printer with 1Yr On-Site Warranty
SCS406003YR	Printer with 1Yr Wty & 2Yr On-Site CoverPlus
SCS406005YR	Printer with 1Yr Wty & 2 x 2Yr On-Site CoverPlus

¹ Figures are maximum engine speeds only. They do not include provisions for image processing, transfer, drying or post production. Nominated speeds may not be suitable for all media types &/ or applications. Alternate print modes may be employed by RIP s/w for different results.
² For details on the MCS program including coverage, certification, terms & conditions please contact your local 3M office.



An optional print drying system integrates with the printer to enable production at high speed & with heavy ink loads



The Ad-ATC & ATU enable roll-to-roll production with superior linearity, parallelism, & tension for off-line processing & tiling applications

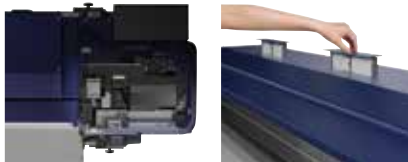

The auto head cleaning & air filtration systems work in conjunction with the headguard to ensure superior reliability with reduced maintenance

Better Products for a Better Future

Epson, SureColor, UltraChrome, PrecisionCore are registered trademarks of Seiko Epson Corporation. All other names and logos herein are for identification purpose only and are trademarks of their respective owners; Epson disclaims any and all rights. All print samples shown herein are simulations. Specifications are subject to change without notice; customers should review material posted on the web sites listed below for the latest information.

V4.0 November



The printer can be managed through the control panel or via Epson Edge Dashboard complete with downloadable print & media profiles, remote e-mail status & error notifications. New Epson Edge Print software enables output of PS, EPS, Tiff, Jpeg, PNG & PDF files with image crop, layout & colour adjustment.



FUJIFILM

For more information or detailed product specification, please call or visit us at

FUJIFILM Business Innovation Australia Pty Ltd

8 Khartoum Road MACQUARIE PARK NSW 2113 Australia | Tel. +61 2 9856 5000 | fujifilm.com/fbau

FUJIFILM and FUJIFILM logo are registered trademarks or trademarks of FUJIFILM Corporation.
V1.0 April 2021